

Roman Blind Systems





Battery Operated Roman Blind System

Silent Gliss® 2345

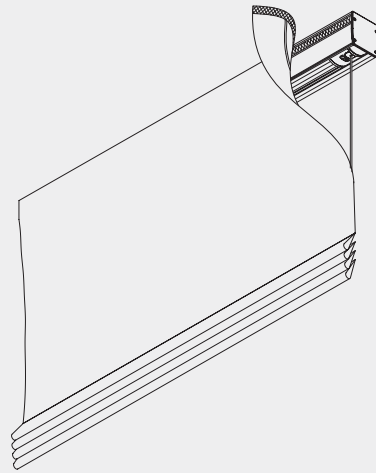

Product Information

- Battery operated Roman blind system for contract and residential applications.
- Elegant appearance as all technique including motor is concealed in cassette.
- Battery pack concealed behind fabric. Batteries can be easily exchanged.
- Long lasting battery life, up to three years (depending on usage, system size, fabric and battery type, room temperature).
- A revolutionary cord release mechanism combined with velcro tape fixing makes maintenance and cleaning of fabric very easy.
- For applications up to a maximum width of 6 m and a maximum drop of 6 m. The maximum load is 2.5 kg.
- Easy ceiling or wall fixing.
- Supplied complete with motor, ready assembled, made-to-measure with fabric. Large and attractive fabric offer.
- Convenient operation with radio wall switches and radio remote controls.



2345

Profile and Bending Information

Cassette

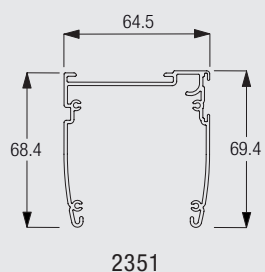

Winding Tube

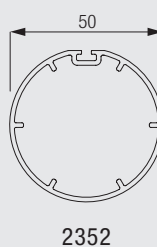

System Dimensions



6 m



60 cm



6 m



2.5 kg (incl. bottom bar
and rods)

System Features

Radio hand-held and wall controls

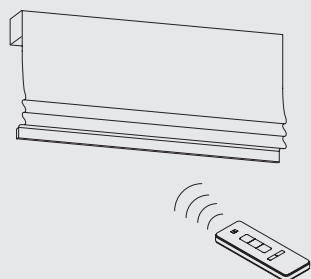

The motor SG 11076 features an integrated radio receiver. Combined with radio remote controls and wall switches, this system offers maximum comfort without wiring.



Battery exchange

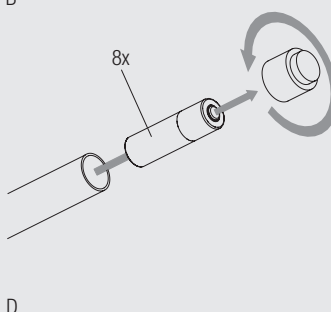
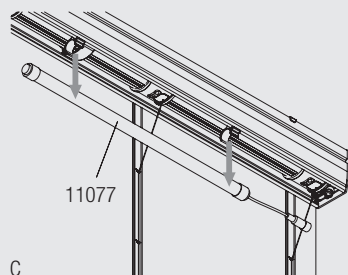
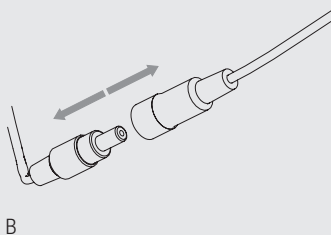
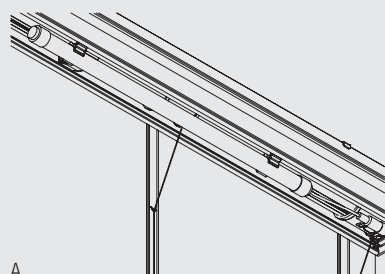

Fitting and Sewing information

Bracket Positioning

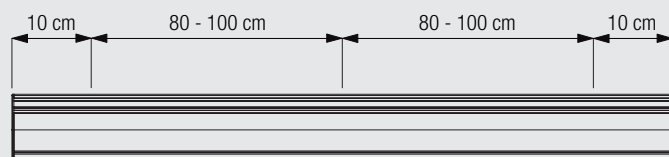

Fixing of cords / tapes

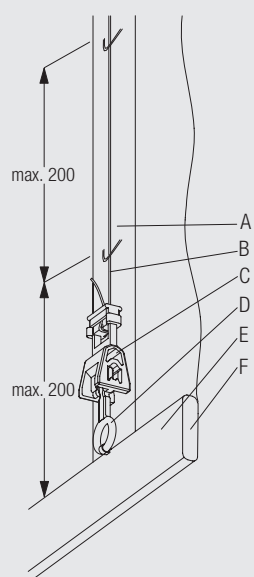

Soft fold with loop tape 3074:

- A: Loop tape 3074
- B: Cord 2216
- C: Child Safety Hook 3075
- D: Child Safety Latch 3076
- E: Hollow hem
- F: Bottom weight bar 2004 / 2016

Please note: Distance no more than 200 mm in all areas on the rear side of the curtain!



2345

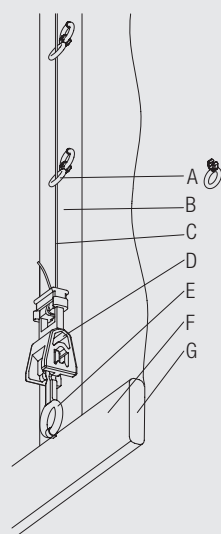

Soft fold with ring tape 2164:

- A: Child Safety Eyelet (soft fold) 3078
- B: Ring tape 2164
- C: Cord 2216
- D: Child Safety Hook 3075
- E: Child Safety Latch 3076
- F: Hollow hem
- G: Bottom weight bar 2004 / 2016

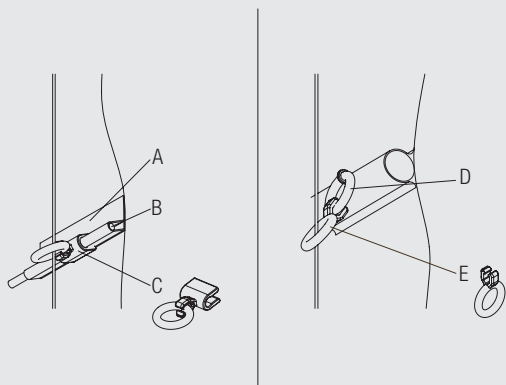

Hard fold:

- A: Tape 2136
- B: Steel rod 2135
- C: Child Safety Eyelet (hard fold) 3069
- D: Ring 2093
- E: Child Safety Eyelet (soft fold) 3078

Easy Washing / Easy Maintenance through Cord Release Mechanism

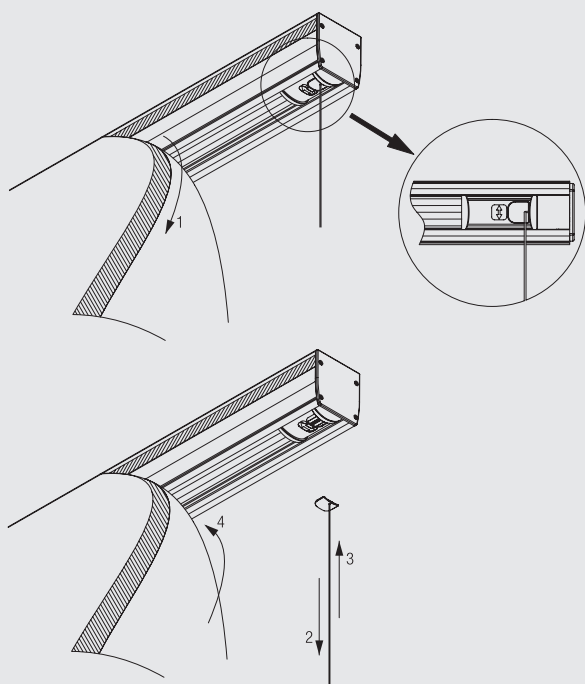

With the new developed cord release mechanism, taking down of the fabric becomes very easy.

- 1: Remove fabric from Velcro in down position of blind
- 2: Take off the pins by pulling on the lift cord
- 3: After washing, just press pins back to the Shell
- 4: Refix fabric to the Velcro tape on Profile

Fitting Options

Ceiling fitting with clamp 3003

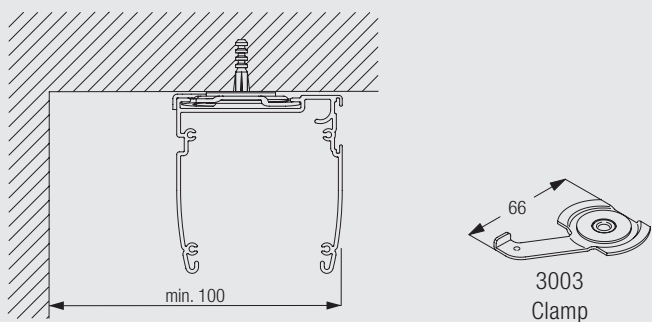

Ceiling fitting with bracket 2521

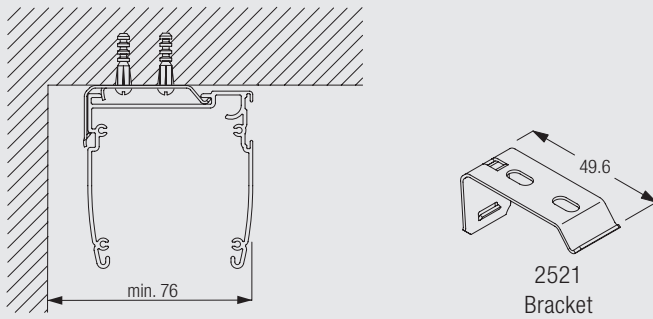

Ceiling / Wall fitting with bracket 2363

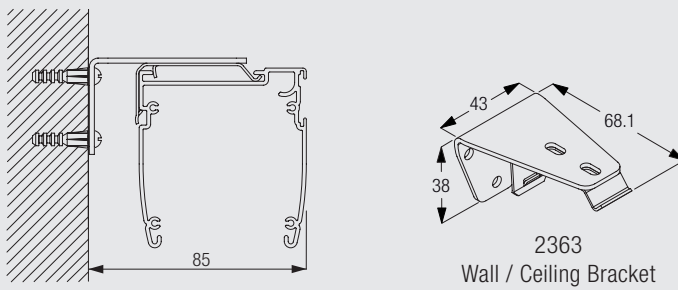

The ceiling fixing with the Bracket 2363 is according to the ceiling fixing with the Bracket 2521.

Wall fitting with brackets 3134-38 and bracket 2521

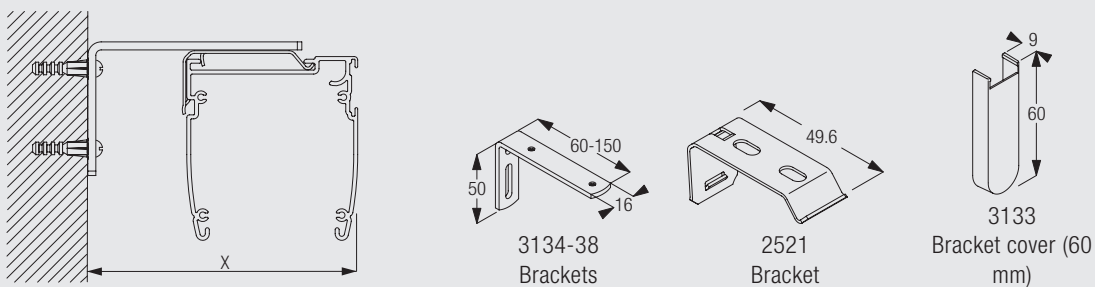

Brackets feature thread for screw M4 x 6 for fixing the Bracket 2521.

Wall fitting with bracket support 3271, bracket plates 3273-74 and bracket 2521

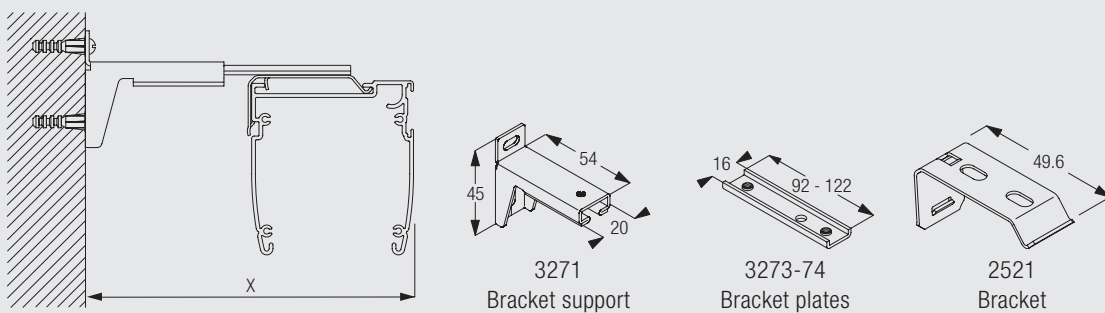

Brackets feature thread for screw M4 for fixing the Bracket 2521.

Standard Accessories

2004	Weight bar		2216	Cord	
2221	Velcro tape		2353	Motor Cover	
2354	Cover		2357	Pin	
2358	Shell		2359	Support	
2361	Adapter		2368	Motor adapter plate	
3003	Clamp		3069	Child safety eyelet (hard fold)	
3075	Child safety hook		3076	Child safety latch	
3078	Child safety eyelet (soft fold)		11071	Motor drive	
11074	Tube adapter		11076	Motor, 1.2 Nm	
11077	Battery box		11085	Battery box holder	
11099	Alkaline AA battery				



2345

Optional Accessories

2136	Hollowtape		2137	Fibre glass rod	
2144	Profile		2363	Wall / Ceiling Bracket	
2521	Bracket		3055	Hook	
3133	Bracket cover (60 mm)		3134	Bracket	
3135	Bracket		3136	Bracket (100 mm)	
3137	Bracket (120 mm)		3138	Bracket (150mm)	

3139	Bracket (200mm)		3271	Bracket support	
3273	Bracket plate (92mm)		3274	Bracket plate (122mm)	
10946	Radio hand-held transmitter, 1 channel		10947	Radio hand-held transmitter, 2+1 channel	
10948	Radio hand-held transmitter, 6+1 channel		10949	Radio wall transmitter, 1 channel	
10950	Radio wall transmitter, 2 channel		10951	Radio wall transmitter, 5+1 channel	

Sewing Accessories

2093	Ring		2539	Tape	
3074	Loop tape (delivery only with fabric)				

Useful Measures

2004	Weight bar		2144	Profile	

2345

Motor & Controls

Motor Silent Gliss 11076

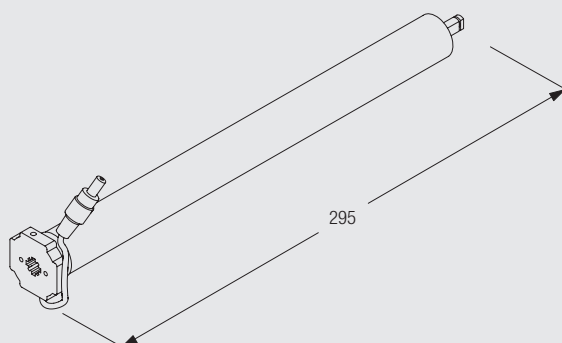

- Voltage: DC 12 V
- Torque: 1.2 Nm
- Speed: 30 rpm
- Power: 6.6 W
- Current: 550 mA

Operation Methods

Radio hand-held and wall controls

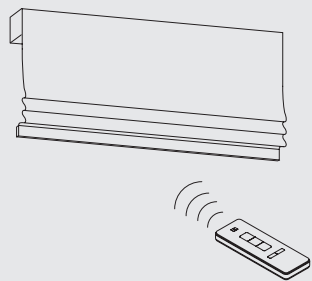

The motor SG 11076 features an integrated radio receiver. Combined with radio remote controls and wall switches, this system offers maximum comfort without wiring.



2345



2345

www.silentgliss.at
www.silentgliss-russia.com
www.silentgliss-cee.com

Silent Gliss GesmbH
Jochen Rindt Straße 1
A - 1230 Wien

Tel. + 43 (0) 1 615 02 72
Fax. + 43 (0) 1 615 02 72-88

Silent Gliss GesmbH
Showroom/Export
Stubenring 6
A – 1010 Wien

Tel. +43 (0) 1 513 16 77
Fax. +43 (0) 1 513 16 77-88